



211/75B Grima Street Schofields NSW

3  **2**  **1** 

Syon Property Group presents this well-considered three-bedroom apartment with an additional study, positioned to capture a north-east aspect and consistent natural light throughout. What sets this residence apart is the seamless connection to the outdoors - with balcony access extending from the living area and all bedrooms, creating a rare level of openness and usability.

Type : Apartment

Price : Contact Agent

View : <https://www.syonpropertygroup.com.au/8688504>

Property Snapshot:

- ? Three bedrooms | Two bathrooms | Dedicated study
- ? North-east facing orientation with consistent natural light
- ? Balcony access from living area and all bedrooms
- ? Open-plan design with strong indoor-outdoor connection



Nilesh Padhiyar
0433 848 485

[For full version visit the website](https://www.syonpropertygroup.com.au)

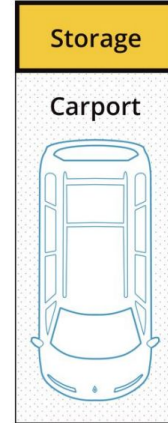
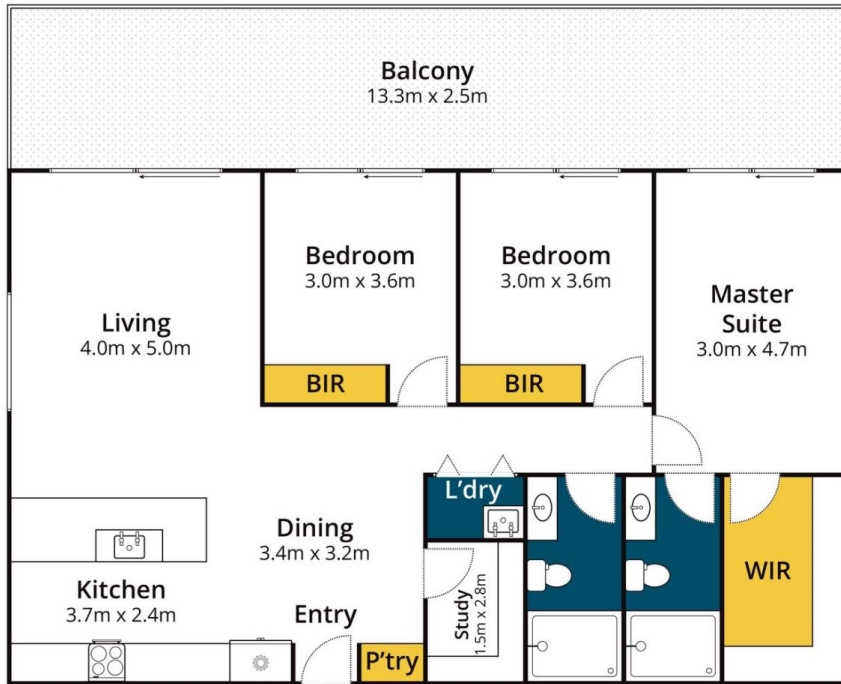

(Not In Position)



Whilst bwrn.com.au has made every attempt to ensure the accuracy of the floor plan contained here, measurements are approximate and no responsibility is taken for any error, omission, or mis-statement. This plan is for illustrative purposes only.